

FAMOUSOUND
The professional

MA系列两通道专业功率放大器

User's Manual 用户使用手册

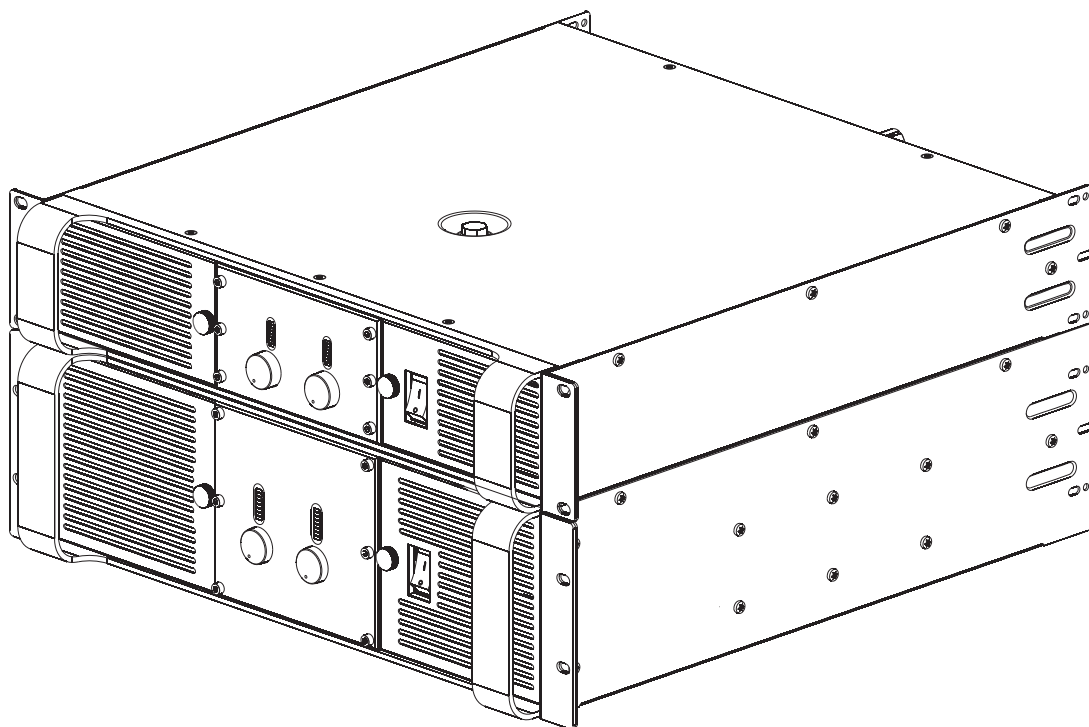

MA800/MA1200
MA2400/MA3600/MA4800



P/N: 020010140010400

中文
English

目录	1
重要安全事项和符号说明	2
前言	3
产品介绍	4
前板功能介绍	5
后板功能介绍	6
系统连接实例	7
组装尺寸图	9
参数表	10
故障排除	11
保修条例	12
产品物质拆分表	13

1. 阅读这些规定。
2. 保存好这本使用手册。
3. 注意所有警告。
4. 遵守这些规定。
5. 警告: 为避免着火或电击, 不要将设备暴露在雨中或潮湿的环境中。
6. 只能用干布擦拭。
7. 不要堵塞通风口。根据制造商的说明进行安装。
8. 不要安装在会产生热量的热源附近, 如散热器、热调节装置、炉子或其它设备。(包括放大器)
9. 勿使接地插头的安全性失效, 本设备应通过保护性接地连接到插座。
10. 保护电线防止被踩踏或挤压, 尤其要注意插头、电源插座及其连接设备处。
11. 在拔掉电源线、信号线或拨动输入模式选择开关、限幅器断开前必须先把功放电源关掉。
12. 必须使用与后板标称电压相符的电源, 若由于使用电压的不恰当而导致的设备损坏将作为有偿服务。
13. 在一个信号要分给多台功放使用的情况, 建议使用信号分配器。
14. 不要将功放的某一个声道的输出接口接到另一个通道的输入接口。不要将功放的输出并联或串联到另一台功放的输出接口来使用。
15. 配置功放的时候, 功放的功率比音箱的标称功率大50%-100%。
16. 在维修功放的时候, 禁止在桥接状态下将示波器的探头连接到功放的输出端, 以免损坏功放和示波器。
17. 建议: 多台功放同时使用时使用时序器供电。



提醒用户本手册中有重要的信息。



机内具有危险电压的非绝缘部分, 足以致人于触电之危。因而不要打开机盖, 维修时必须请专业人员检修, 或送返厂家。

前言

欢迎

非常感谢你购买蜚声演出器材制造有限公司产品。MA 系列是本公司研发的CLASS-I类专业功放采用专业发烧级元件制造。适合各种类型高品质音响重放应用，特别适合娱乐方面的用途。为了更好的发挥产品的性能，请仔细阅读本手册。

拆包

请在拆开包装后，确认功放的外观没有在运输途中遭到损坏。确认功放的预设电压和你所在地的交流电压额定值匹配（详细信息见功放背板印刷）最好不要扔掉包装箱，以便在需要退还功率放大器时使用。

支持与服务

请直接联系蜚声演出器材制造有限公司在当地的经销商，以获得快速的售后服务和技术支持，如有技术问题需要直接与制造商联系，可以通过以下方法：
电子邮件：support@saechina.com
传真：+86-757-8568-8191

重要的安全注意事项

蜚声演出器材制造有限公司的产品设计已经考虑到安全使用的要求，并遵照相关的国家的安全规定检验出厂产品，只有合格的产品才能出厂销售。但由于本产品内部有危险高压和电量，因此要求用户必须认真阅读本手册的注意事项。如果产品跌落、凹入、浸湿或者里面有部件松动，则会大大增加人被电击的危险。当发生以上的问题时，请马上拔下电源线然后将本产品送还指定的经销商进行维修，禁止自己开机检查！

功率额定值

*, 此功率是按照EIA标准测量得出。
**, 此功率是使用40ms脉冲1kHz正弦波在1%总谐波失真下测量得出。

型号	8 欧姆*	4 欧姆*	2 欧姆**
MA800	700Wx2	1050Wx2	1500Wx2
MA1200	900Wx2	1500Wx2	2250Wx2
MA2400	1200Wx2	2000Wx2	3000Wx2
MA3600	1500Wx2	2400Wx2	3500Wx2
MA4800	1800Wx2	3000Wx2	4500Wx2



简介

MA系列着重于对声音的准确还原、性能稳定，外观设计时尚大方。具有能耗低、声音靓、工作稳定、可靠性高的特点。

技术亮点

- * 采用背光面板设计，即使在夜晚也能清晰看见各种功能指示。
- * 主放大器电路拓扑，采用本公司开发的新型高效的CLASS-I技术。CLASS-I比CLASS-H 在波形的还原和动态能耗方面有非常明显优势。特别在2欧立体声音箱负载，可以在合理的环境下，长期稳定工作,音质更是一流。
- * 持续输出短路保护功能，可以提高使用的安全性。
- * 专业音频处理的技术应用:光耦隔离线性VCA音量控制电路(本公司的专利技术)
专利号：ZL 2009 2 0049758.9

高质材料的选择

- * 高频低噪优良线性小功率对管，高频大功率音响对管做推动。
- * 音频耦合，采用国际知名品牌音频专用电解。
- * 优质环形变压器，专用电源滤波电解，电源储备十足，反应迅猛。
- * 面板的电源开关用过流自跳开的液压电磁断路开关, 比用保险丝更安全可靠。

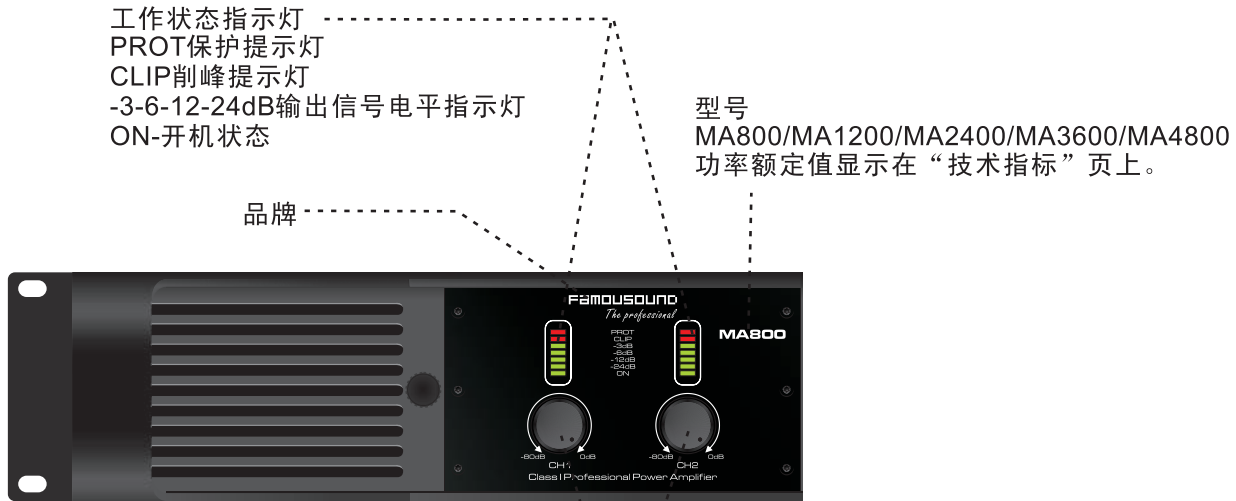

增益控制
CH1/CH2, 300度音量旋钮0/-80dB。
立体声/并接模式:CH1与CH2音量独立控制。
桥接模式:CH1同时控制两通道音量衰减, CH2音量控制失效。
对于正常使用, 将控制器保持在最大(0dB)。

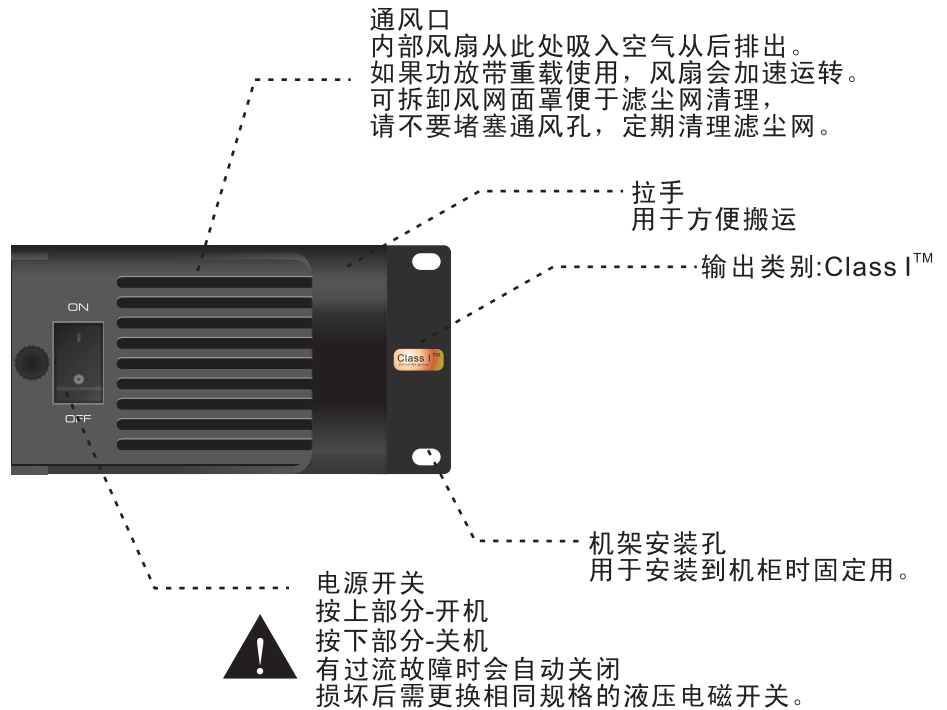

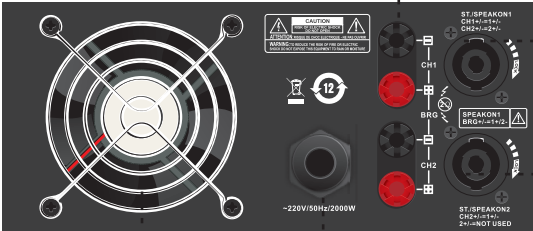

风扇通风口
在使用过程中，
请不要堵塞出风口。

交流输入

扬声器连接实例1
接线柱
裸线或端子
可插入侧孔

扬声器连接实例2
SPEAKON 线（2线型）
插入后转动直到
听到接头发出咔
的一声。使用指
按门栓松开插头。

灵敏度选择开关(ON <input type="checkbox"/> OFF)			
CH1	<input type="checkbox"/>	<input type="checkbox"/>	<input type="checkbox"/>
CH2	<input type="checkbox"/>	<input type="checkbox"/>	<input type="checkbox"/>
输入电平	0.775V	1V	32dB

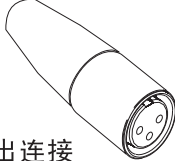

输出连接
平衡XLR输出
引脚2：正极，引脚3：负极，引脚1：接屏蔽(接地)
用于连接下一台功放，多台功放连接时，
建议使用信号分配器。

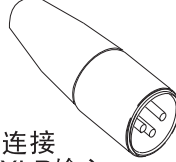

输入连接
平衡XLR输入
引脚2：正极，引脚3：负极，
引脚1：接屏蔽(接地)。
建议：用于放大器与信号源之间的长或短距离使用。

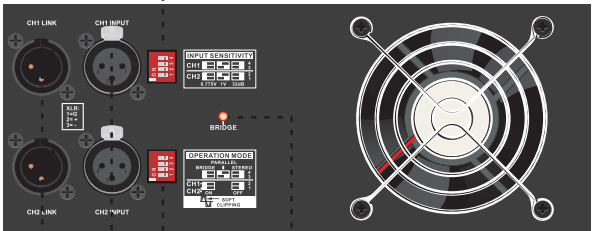

桥接状态指示灯
立体声/并接/桥接切换(DIP/3-4)
CH1柔剪切换(DIP/2)
CH2柔剪切换(DIP/1)

连接实例 1

MA系列功率放大器

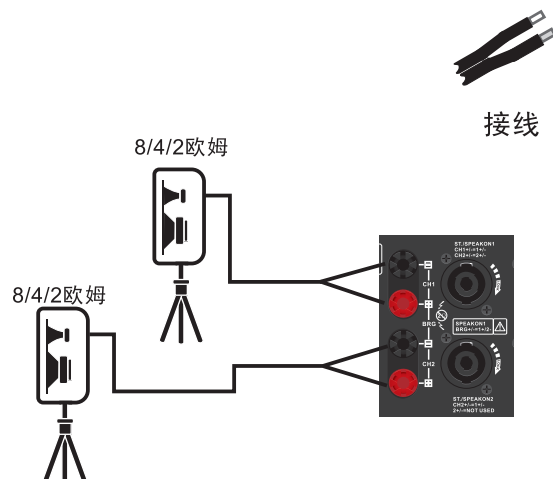
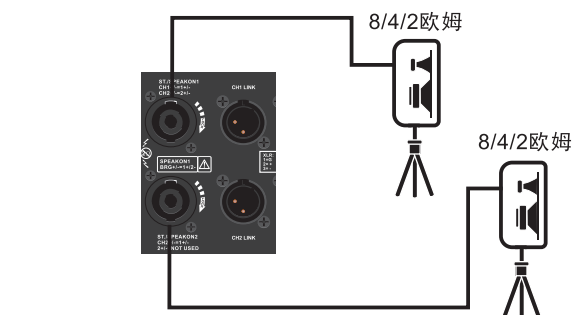
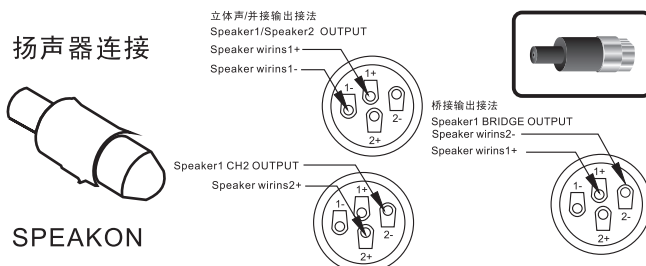
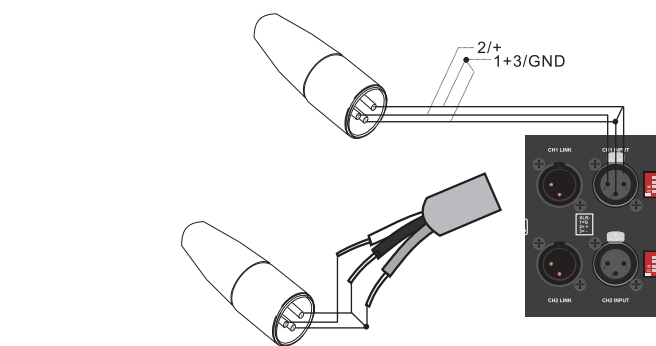
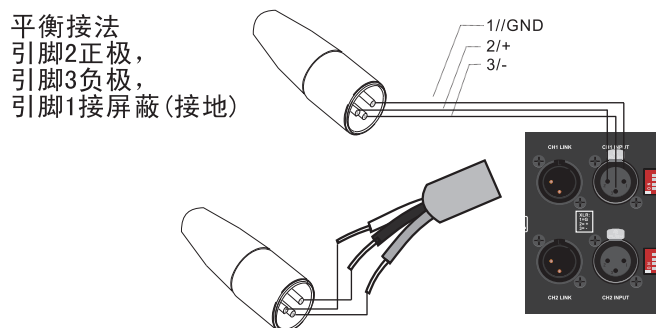
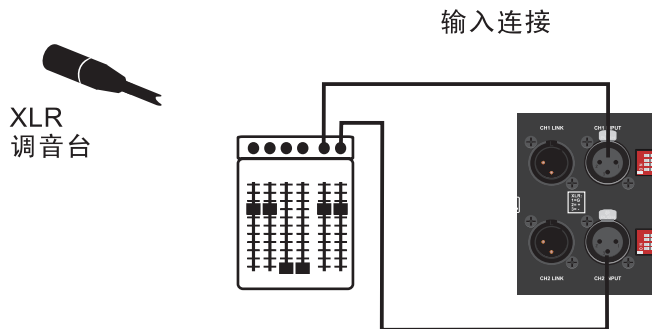

每一通道可连接两个8欧姆扬声器到各个通道

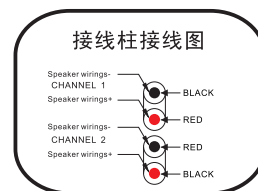
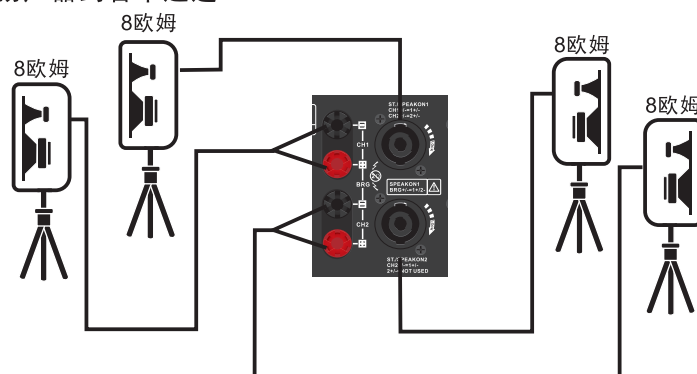

连接实例 2

MA系列功率放大器

每一通道可连接两个4欧姆扬声器到各个通道

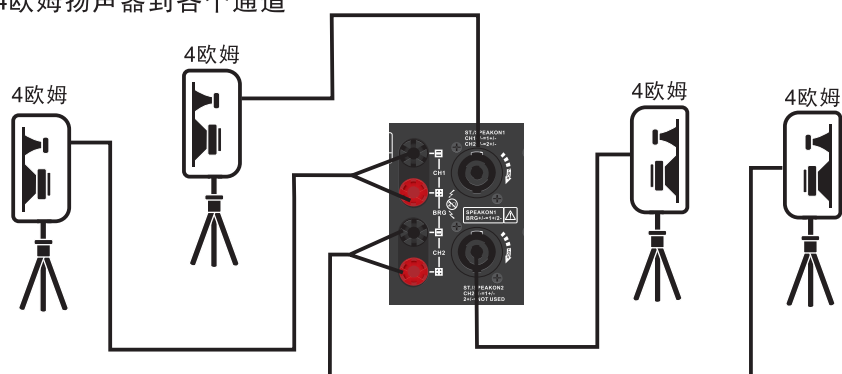

每一通道连接的扬声器阻抗不低于2欧姆

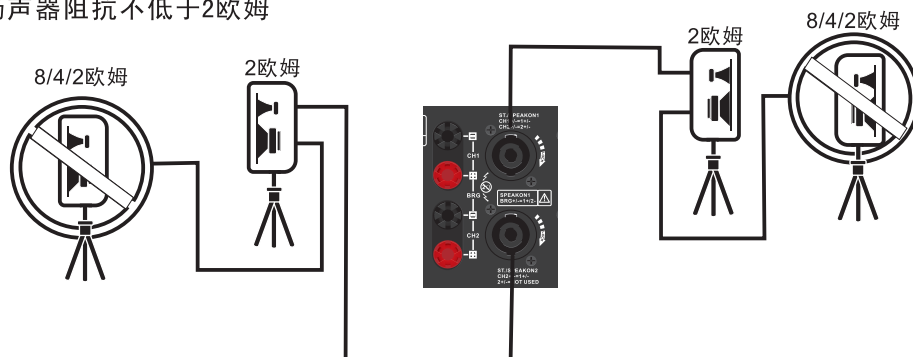

桥接时，连接的扬声器阻抗不低于4欧姆

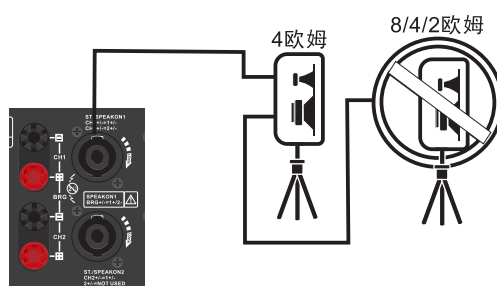

请不要将两通道的输出
连接同一音箱！

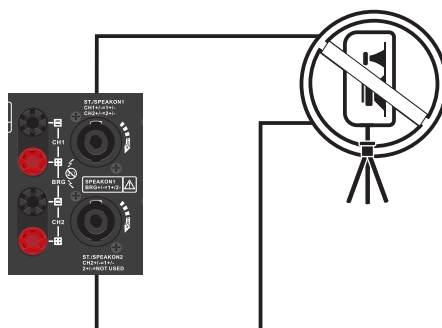

机箱尺寸（厘米）

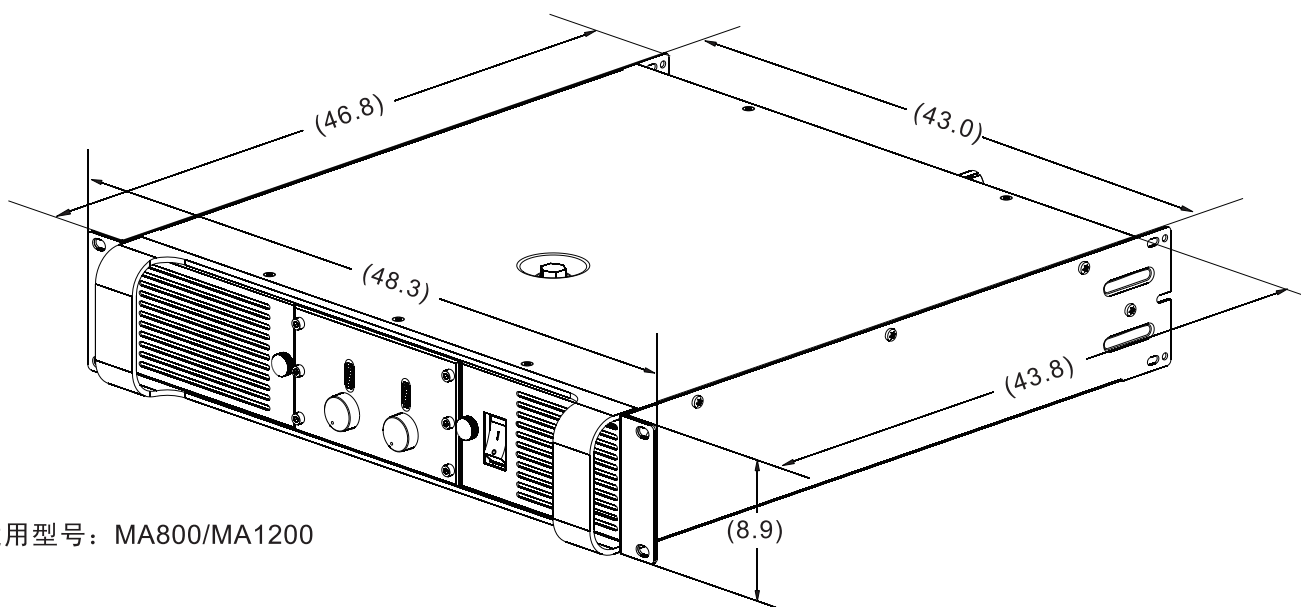

适用型号：MA800/MA1200

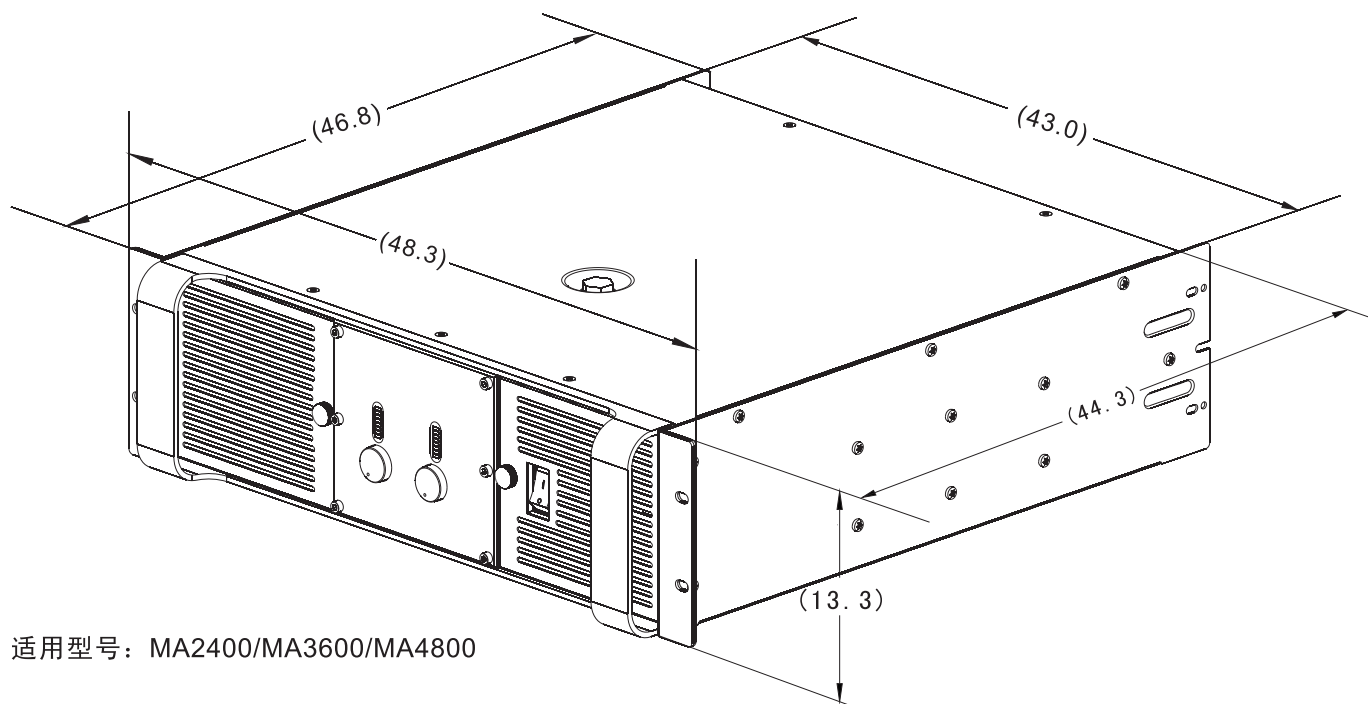

适用型号：MA2400/MA3600/MA4800

型号	MA800	MA1200	MA2400	MA3600	MA4800
功率					
8 Ω 立体声功率*	700Wx2	900Wx2	1200Wx2	1500Wx2	1800Wx2
4 Ω 立体声功率*	1050Wx2	1500Wx2	2000Wx2	2400Wx2	3000Wx2
2 Ω 立体声功率**	1500Wx2	2250Wx2	3000Wx2	3500Wx2	4500Wx2
8 Ω 桥接功率*	2100W	3000W	4000W	4800W	6000W
4 Ω 桥接功率**	3000W	4500W	6000W	7000W	9000W

其他参数

频率响应	20Hz-20kHz(+0/-0.5 dB)				
总谐波失真	$\leq 0.2\%$				
信噪比	$\geq 90\text{dB}$				
阻尼系数	> 100				
分离度	$\geq 60\text{dB}$				
转换速率	$> 10\text{V}/\mu\text{s}$				
输入灵敏度	0.775V/1V/32dB				
输入阻抗(平衡/不平衡)	20k Ω / 10K Ω				
电压增益 (8欧时)	39.7dB	40.8dB	42dB	43dB	43.8dB
输出类别	Class I TM				
冷却	抽风向后吹出				
保护功能	软启动、VHF、直流、短路、过载、失真限幅、过热、开机音量渐大				

连接

输入	平衡输入XLR母插座、平衡并接XLR公插座				
输出	两位红黑接线柱、NL4型SPEAKON插座				
功能					
前面指示灯	面板指示灯: 削峰、保护、信号指示、电源指示 后板指示灯: 桥接指示				
前面板	电源开关、音量控制旋钮, 采用背光面板设计 即使在夜晚也能清晰看见各种功能指示				
后面板	立体声、并接、桥接选择开关、灵敏度选择开关、柔剪开关				

尺寸/重量

产品外形尺寸 (毫米)	483x493x89 (2U)		483x493x133 (3U)		
外包装尺寸 (毫米)	620x595x170 (2U)		620x595x210 (3U)		
毛重($\pm 2.5\text{kg}$)	23.5kg	27kg	34.5kg	36.5kg	38.5kg
供电要求	13A美标电源线 AC220V/50Hz. $\pm 10\%$ AC240V/50Hz. $\pm 10\%$		2.5平方电缆 AC220V/50Hz. $\pm 10\%$ AC240V/50Hz. $\pm 10\%$		

注意: 1、*, 此功率是按照EIA标准测量得出。
2、**, 此功率是使用40ms脉冲1kHz正弦波在1%总谐波失真下测量得出。
3、其他数据按: Q/SAE 1-2009标准测试得出。
4、SAE保留对以上参数的解释权, 参数有所变动恕不再另行通告, 最后参数以产品说明书为准。

无任何反应

确认将交流线完全插入并连接到了有电的插座。试着试着使用其他设备检验交流电源，比如灯。检验放大器面板的电源开关是否跳开，如果跳开时将开关打到ON即可。如开关再次跳到OFF则需要对放大器进行维修。

放大器失音

如果放大器工作负载过重，风扇全速运转，适当降低输入信号，1-2分钟后放大器应回到正常增益。如果放大器发烫，而且风扇不转，则需要对其进行维修。

通道2输入似乎无效。

检验后板上模式开关是否在立体声位置。并接与桥接时通道2输入无效。

左右声道灵敏度不一致

确认音量控制器设置是否一致。（建议：正常使用时将音量开至0dB）
确认输出喇叭的阻抗是否一致。

放大器声音失真。

如果红色CLIP（削波）LED闪动则放大器工作超过正常的额定功率。压限电路会适当降低音量以防出现严重过载，但如果输入信号继续增加，限幅器可能会被跨过，造成失真增大。

如果扬声器或扬声器缆线过短或发生故障。在低于正常水平下，放大器可能会失真或无声，并且红色CLIP（削波）LED的闪动会增加。应该使用其他扬声器和缆线对其进行检查。

如果各通道阻抗低于2欧姆，连接的扬声器过多，放大器会很容易过载并且可能会发烫。

如果声音失真或不清晰，但红色CLIP（削波）LED不闪动，则放大器内部没有出现失真。

可能是扬声器损坏或者输入信号失真。

- 1.使用其它设备确认扬声器是否完好。
- 2.如果放大器增益控制设定过低，可能会出现输入过载，输入源会超负荷运行。降低源音量直至失真清除并将放大器增益提高到理想的水平。通常希望将放大器增益设定为最大(0dB位置)或接近最大。
- 3.检查所有的输入连接。不要将两个不同的音源接入同一通道。建议使用混音器混合音源。

无声音，

确认打开了增益控制。确认两端的输入缆线安装无误。确认有音源输入。如果需要，可使用其他音源或者将其他放大器连接到现有音源。

无声音但是SIG（信号）LED有点亮表示放大器有信号输出，因此如果连接了扬声器的话应能够听到声音。检查扬声器连接，试用另一扬声器。

无声音：PRT（保护）和LED 点亮

如果放大器过热严重，也会静音，直至冷却下来。风扇将全速运转，声音应该在几分钟内恢复。如果放大器摸上去很热，并且风扇没有运转，则需要对其进行维修。

嗡嗡的背景声

平衡XLR 缆线更适合长距离运行。如果采用非平衡连接（单芯线）使用，嗡嗡声可能会是个问题，因为非平衡连接，通常会引入干扰。

根据连接类型的不同，嗡嗡声还可能会在信号链中更早出现。如果总功率消耗不是太大，全部插入同一交流跨接片上会有很多好处。

最后，中度的嗡嗡声有时通过降低放大器增益，并提高源增益进行补偿可能会降低，但是必须要确保声源可以提供足够大的声音而不会产生过载失真。如果嗡嗡声没有降低，那么它可能来自音源。

以下情况表示放大器需要维修

- 1.如果放大器冒烟或者发出烧焦味
- 2.如果机箱严重凹陷或者变形
- 3.如果放大器浸入液体中
- 4.如果内部部件松动
- 5.如果加电时开关跳开

免责声明

制造商蜚声演出器材制造有限公司对于因疏忽或安装不当使用本产品对扬声器产品或其他设备所造成的任何损坏不承担任何责任！

制造商蜚声演出器材制造有限公司 对本产品提供2年有限质量保证。

制造商蜚声演出器材制造有限公司担保其产品自销售之日起2年内不会发生材料和/或制造工艺缺陷；若在正常安装和使用条件下发生的损坏，制造商蜚声演出器材制造有限公司将按照本质保协议无偿更换有缺陷的零件和维修故障产品。但客户必须将产品送回我们的工厂或任意授权的维修点或指定经销商处，同时必须预付运费和附带购买证明（产品保修卡客户联及销售收据或发票复印件）。

此质保协议规定，退回的产品必须经过我们检查断定存在制造缺陷。本质保不适用于任何误用、疏忽、意外、不正确安装或日期编码、序列号被去掉或破损至不能辨认的产品。

制造商蜚声演出器材制造有限公司不对意外或间接发生的损害承担责任。

此质保赋予你特定的法律权利。

通讯地址：

蜚声演出器材制造有限公司 售后服务部收

中华人民共和国，广东省，佛山市，南海区，和顺，文教路东段39号，蜚声工业园。

邮政编码：

528241

电话：

0757-8560-8331

传真：

0757-8568-8191

电子邮件：

support@saechina.com

品牌网址：

www.famousound.com

制造商网址：

www.saeaudio.com

产品物质拆分表

为满足中国《电子信息产品污染控制管理办法》（信息产业部第39号令）的相关规定和要求，现对产品中有害物质，按部件分类，声明如下：

部件名称	有毒有害物质或元素					
	铅（Pb）	汞（Hg）	镉（Cd）	六价铬（Cr(VI)）	多溴联苯（PBB）	多溴二苯醚（PBED）
机箱	×	○	○	○	○	○
主板模块	×	○	○	○	×	×
电源模块	×	○	○	○	×	×
I/O板模块	×	○	○	○	×	×
控制模块	×	○	○	○	×	×
灯板	×	○	○	○	×	×
备注： ○：表示该有害物质在该部件所有均质材料中的含量均在SJ/T11363-2006规定的限量要求下 ×：表示该有害物质至少在该部件的某一均质材料中的含量超出SJ/T11363-2006规定的限量要求。						

在中华人民共和国境内销售的电子信息产品上将贴上有“环保使用期限”（EPuP）符号。圆圈中的数字代表产品的正常环保使用年限。



Directory	14
Important precautions and application note	15
Preface	16
Product introduction	17
Front panel function introduction	18
Rear panel function introduction	19
System connection examples	20
Cabinet dimensions	21
Specifications	23
Troubleshooting	24
Warranty	25

1. Read this user manual before operation.
2. Retain this user manual.
3. Pay attention to all the notice.
4. Comply with these regulation.
5. Warning: To avoid causing fire or hit by the thunder, don't put the equipment in the rain or in the wet environment.
6. Wiped by dry cloth.
7. Don't obstruct the air entrance and exit.
8. Don't install the equipment closed to heat source radiator, heat adjust setting, camp stove etc ,for example.....
9. Don't make the grounded plug invalidation, this equipment should be connected to the socket by protective grounding.
10. Protect the power from being trampled or extruded, especially the socket, power socket and the connectors of it.
11. Please turn off the power cord before taking off the power cord, signal wire or to change the mode and switch off.
12. Please use the equipment under suitable voltage remarked on the rear panel. If the equipment is damaged because of using under wrong voltage, it is not included in the warranty regulation.
13. If there is one signal is used for more than one power amplifiers, we suggest using signal distributor.
14. Don't connect the output of one channel to the input of another channel of the power amplifier. Don't connect one power amplifier to another one by connecting their output in series or parallel connection.
15. When using, the power of the power amplifier should be 50%-100% more than the loudspeaker power.
16. During service of the power amplifier, don't connect the probe of the oscilloscope to the output interface under bridge mode in case of damaging the power amplifier and the oscilloscope.
17. Suggestion: Sequence power should be used when use more than one amplifiers.



Warning: important notice.



There are non-insulated parts with dangerous voltage, which can make people get electric shock. Hence, please don't open the cover. please ask the professional for repair or return to the factory. If maintenance is needed.

Welcome

Thank you very much for your purchasing our product. MA series is the latest developed SAE with patent Class I technology. All the components inside are all with professional grade.

It performances well in high quality replaying, especially for entertainment. to make operate wen and correctly of the equipment, please read this manual carefully.

Unpack

Please confirm if the appearance of the power amplifier is damaged during the transportation after you unclosethe pack and if the set voltage matches to your local voltage (Please refer to the print on the back panel for detail information.) Please don't throw away the packing box in case returning the power amplifier when need.

Support and Service

Please contact the local distributors directly in order to get quick after-sales service. If any techniqueproblem, please contact the manufacturer by:

Email: support@saechina.com

Fax: +86-757-8568-8191

Important precaution

The design of the SAE products has already taken the safety requirement into consideration and all the finished products have been tested under the requirement of the government before sale. But as there is dangerous high voltage and electricity inter the products,user must read the notice in this manual. If the product falls down, recess in the appearance, soaked or there is some part looses inside, it will crease the dangerous of getting electric shock. If there are problems above, please take off the power cord and send the product to the local distributor for service. Don't open the product to check by yourself

Rated Power

* The power is tested under EIA standard.

**The power is tested under the condition of 40ms burst, 1KHz sine wave and 1% THD.

Model	8 ohm*	4 ohm*	2 ohm**
MA800	700Wx2	1050Wx2	1500Wx2
MA1200	900Wx2	1500Wx2	2250Wx2
MA2400	1200Wx2	2000Wx2	3000Wx2
MA3600	1500Wx2	2400Wx2	3500Wx2
MA4800	1800Wx2	3000Wx2	4500Wx2



Introduction

MA series focus on accurate sound replay, stable performance and fashion appearance design.

With low energy consumption, excellent sound quality, and high stability and reliability very stable and reliable.

Technology Highlights

- * Front panel adopting backlighting design, makes the function indicators can be seen clearly even at night time.
- * Adopt high efficiency SAE patent Class-I topology circuitry. Class-I has obvious advantages in wave reduction and dynamic energy consumption (especially when loading at 2 ohm stereo), this product can work stable for long time and also with excellent sound quality in reasonable environment.
- * continuously output short circuit protection function, increases the security.
- * Adopt professional audio processing technology: coupling isolation linear VCA volume control circuit (SAE patent technology)
Patent number: ZL 2009 2 0049758.9

High quality materials

- * High frequency low noise reliable small linear power transistor, high frequency high power transistor as driver.
- * Audio coupler, use special audio capacity from world famous brands.
- * With high quality transformer and special power supply filter capacity, enough power reserve and respond quickly.
- * Use Hydraulic electromagnetism circuit breaker more secure and reliable than fuse.

Working condition indicator
 PROT protection indicator
 CLIP clip limit indicator
 -3-6-12-24dB output signal
 electronic level indicator
 ON-working condition

Model
 The rated power of MA800/MA1200/MA2400
 MA3600/MA4800 states in the "Specification".

LOGO



Gain control
 CH1/CH2, 300° volume control knob.
 CH1 and CH2 volume control independently under stereo/parallel mode.
 CH1 mode control two channel volume at the same time when under bridge mode.
 For normal operation, please keep the controller at max (0 db).



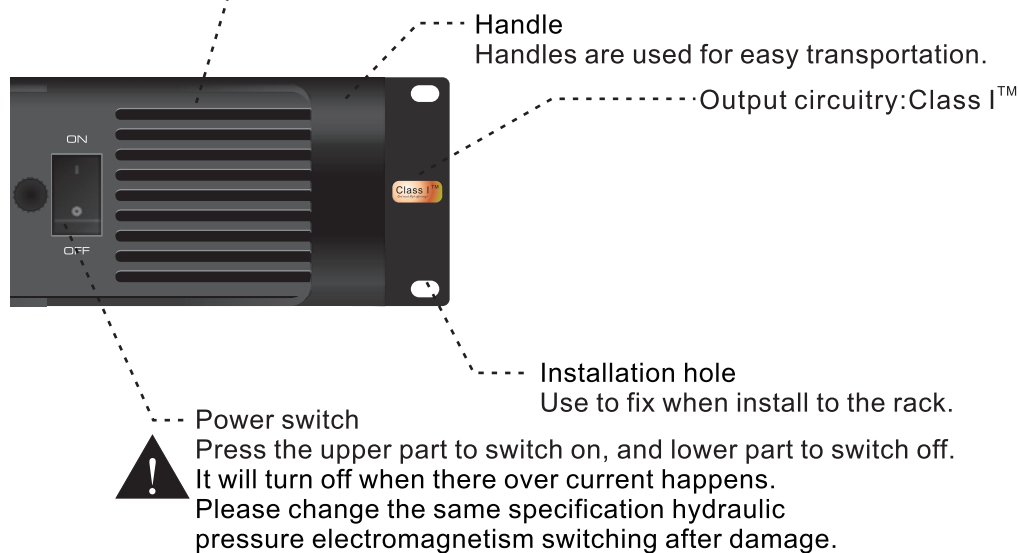

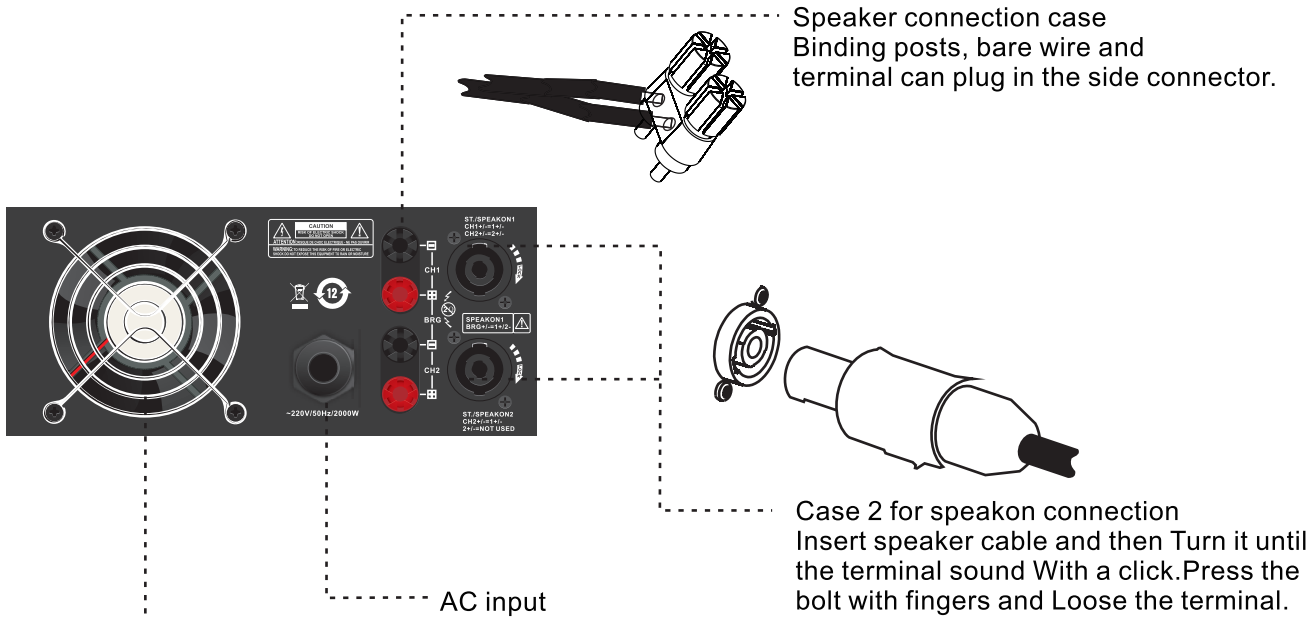
Intake
 Inter fan will soak the air flow from front to rear.
 If the power amplifier is used with heavy load, the fan will run more quickly. Removable network mask make it easy to clean, please don't block the intake, clean the network mask regularly.



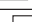

Vent

It is not recommended to block the vent during operation.

Sensitivity selector switch(ON  OFF)		
CH1		
CH2		
Input level	0.775V	1V 32dB

Output connection
Balance xlr output

Feet 2 connects positive pole, feet 3 connects Negative pole, and feet1 connects ground pole
When connect with another or more amplifiers, it is suggested to use signal distributor.

Input connection
Balance xlr input

Feet 2 connects positive pole,
Feet 3 connects negative pole,
And feet1 connects ground pole
It is recommended to adopt this way for operation in long or short
Distance between the amplifier and signal source.

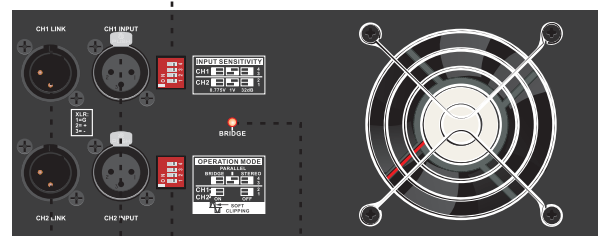

Bridge mode indicator

Stereo/Parallel/Bridge Switching(DIP/3-4)
CH1 soft cut switching
CH2 soft cut switching

System connection examples

MA Series Power Amplifier

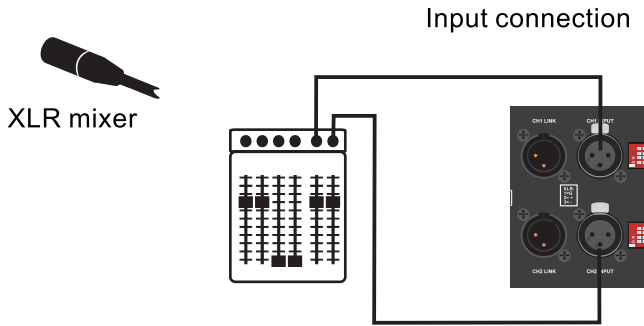

Balanced connection
 Feet 2 to positive pole
 Feet 3 to negative pole
 Feet 1 to grounding pole

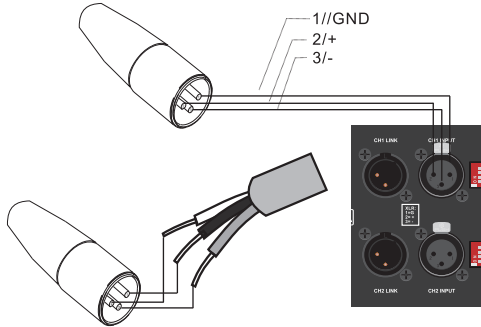

Unbalanced connection
 Feet 2 to positive pole feet 1 & feet 3 to negative pole.
 This connection is only applied for short distance transport between amplifier and signal source, and may cause noise in different application environment. (Suggest no use)

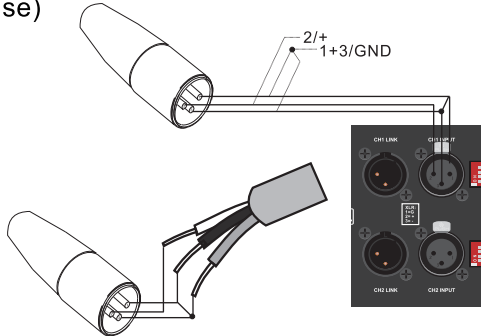

Speaker connection

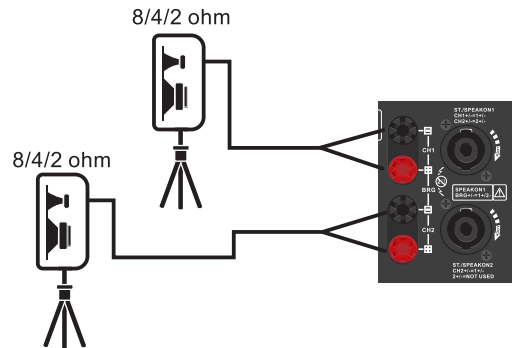
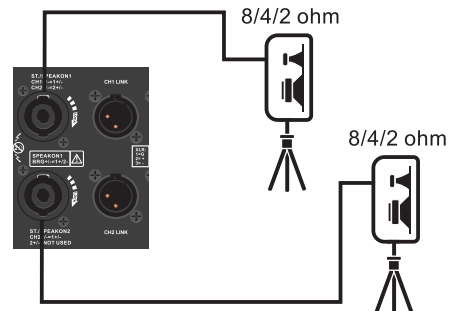
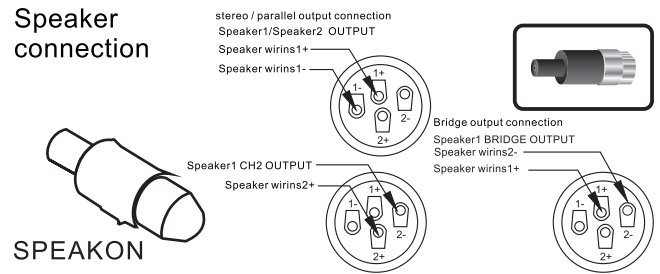

Connect

Each channel can respectively connect two 8ohm speakers.

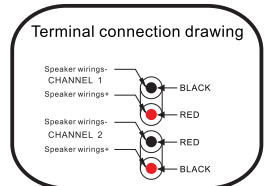
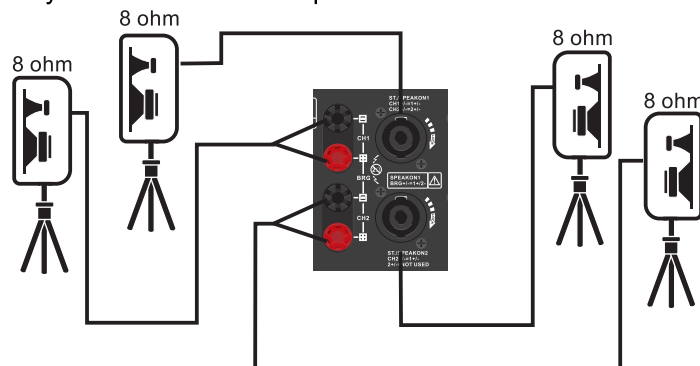

Every channel can connect to two 4 ohm loudspeakers.

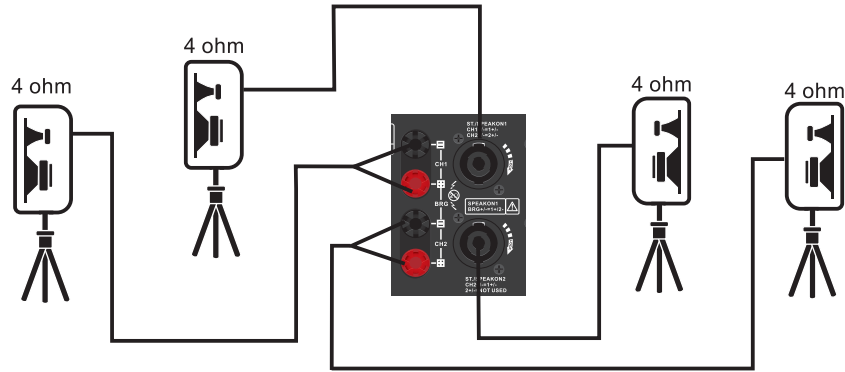

The impedance of the loudspeaker of each channel can't be lower than 2ohm.

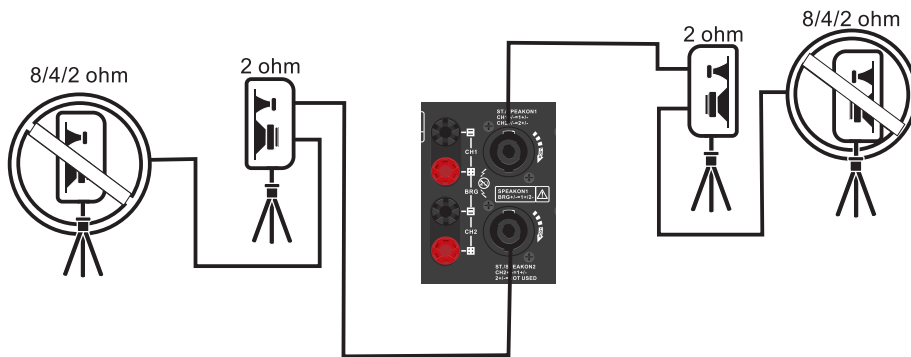

When bridge, the loudspeaker of each channel can't be lower than 4ohm.

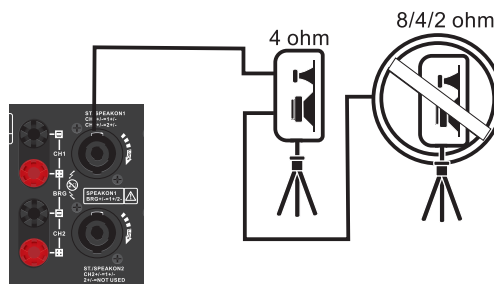

Please don't connect the output terminals of both channels with the same speaker.

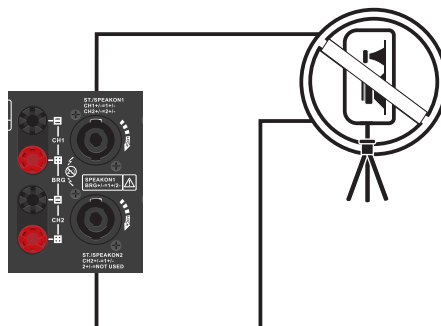

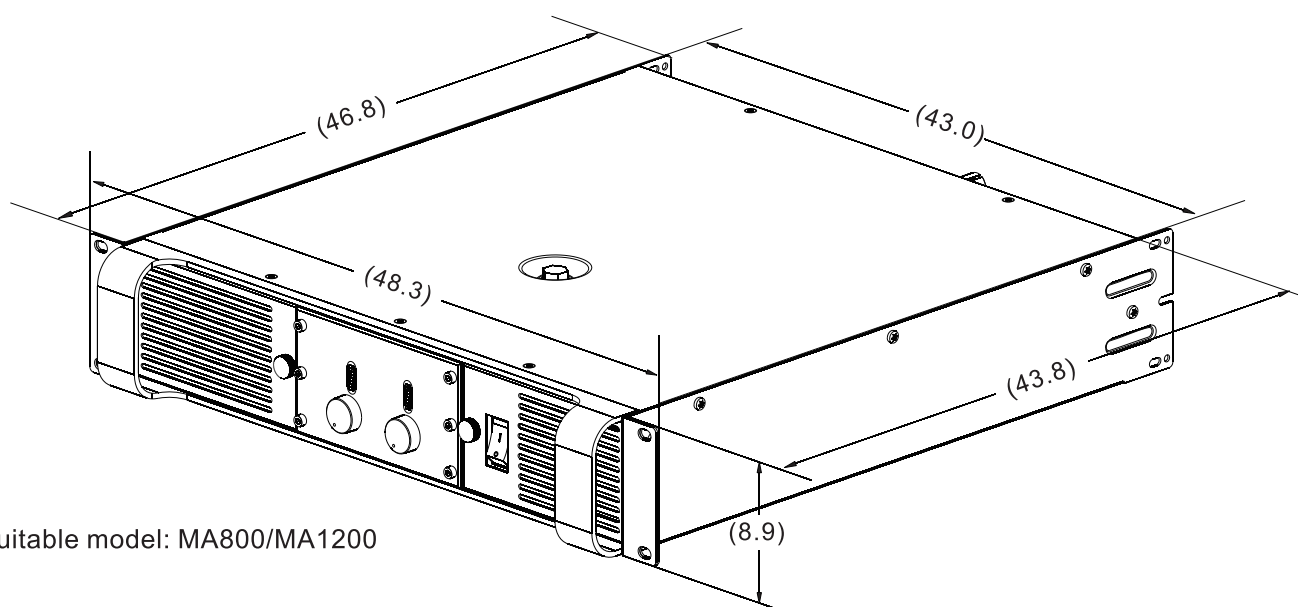
Cabinet dimension (cm)

Suitable model: MA800/MA1200

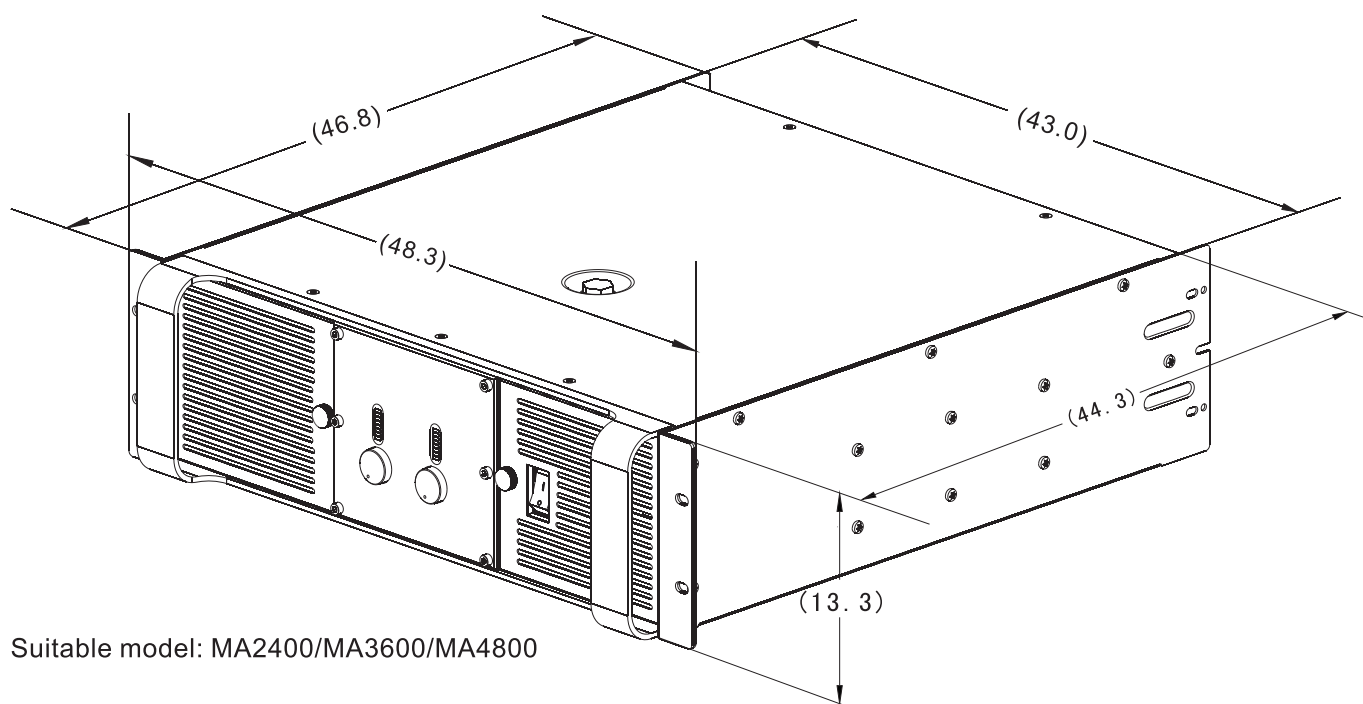

Suitable model: MA2400/MA3600/MA4800

Specifications(220V/240V)

MA Series Power Amplifier

Model	MA800	MA1200	MA2400	MA3600	MA4800
Power					
8 Ω stereo power*	700Wx2	900Wx2	1200Wx2	1500Wx2	1800Wx2
4 Ω stereo power*	1050Wx2	1500Wx2	2000Wx2	2400Wx2	3000Wx2
2 Ω stereo power**	1500Wx2	2250Wx2	3000Wx2	3500Wx2	4500Wx2
8 Ω bridge power*	2100W	3000W	4000W	4800W	6000W
4 Ω bridge power**	3000W	4500W	6000W	7000W	9000W

Other Specification

Frequency response	20Hz-20kHz(+0/-0.5 dB)				
THD+N	$\leq 0.2\%$				
S/N rate	$\geq 90\text{dB}$				
Damping Factor	> 100				
Crosstalk	$\geq 60\text{dB}$				
Slew Rate	$> 10\text{V}/\mu\text{s}$				
Input Sensitivity	0.775V/1V/32dB				
Input Impedance(bal/unbal)	20K Ω /10k Ω				
Voltage gain (8 Ω)	39.7dB	40.8dB	42dB	43dB	43.8dB
Output circuitry	Class I TM				
Cooling	Air flow from front to rear				
Protection	Soft start, DC, short circuit, over load, clip limit, over heat, progressive volume, VHF				

Connector

Input	Balance input XLR-F,Balance output XLR-M
Output	Two red and black Binding posts,NL4 SPEAKON
Function	
Front panel Indicator	Front panel indicator: Clip, protection, signal indicate, power indicate Rear panel indicator: Bridge indicate
Front panel	Power switch, volume control knob, Adopting backlighting design see it clear in dark place easily.
Rear panel	Stereo switch,Parallels witch, bridge switch,Sensitivity choice switch soft switch

Dimension/weight

Product dimension (mm)	483x493x89 (2U)		483x493x133 (3U)		
Packing dimension (mm)	620x595x170 (2U)		620x595x210 (3U)		
G.W($\pm 2.5\text{kg}$)	23.5kg	27kg	34.5kg	36.5kg	38.5kg
Power	13A power cord: AC220V/50Hz. $\pm 10\%$ AC240V/50Hz. $\pm 10\%$		2.5 square meter cable AC220V/50Hz. $\pm 10\%$ AC240V/50Hz. $\pm 10\%$		

Remark:

- 1、*,The power is tested under EIA standard.
- 2、**The power is tested under the condition of 40ms burst, 1KHz sine wave and 1% THD.
- 3、Other data is tested under Q/SAE 1-2009 standard.
- 4、SAE reserves the right to make changes in specification without prior notice. The final specification is subject to the user manual.

No response

Make sure that the AC cord is completely inserted in the socket with electricity. Try to use other equipment to test the AC power, like the lamp. Inspect the amplifier. Check the power switch in front panel jump to "OFF", if does, please put it to "ON". If switch jump to "OFF" again then the maintenance for the amplifier is needed.

Amplifier loses voice

If the amplifier over loads too much, When fan work at full speed, please reduce input signal properly. After the input signal decrease appropriately, amplifier will return to normal gain in 1-2 minutes. If amplifier burned and fans don't work, the maintenance is required.

Input of Channel 2 is of no avail. Check whether the mode switch at the rear panel is at the stereo position. With parallel and bridge, input of Channel 2 is of no avail.

Sensitivity for both channels is inconsistent

Make sure whether the setting of volume controller is consistent or not. (Suggestion: turn the volume to 0 dB at the normal operation.) Refer to the dB Make sure whether the impedance of output speaker is consistent or not.

Amplifier sound is distorted

If the red CLIP LED is flashing, that means the amplifier works beyond the normal rated power. Clip circuit will appropriately reduce the volume to avoid a serious overload, but if the input signal continues to increase, limiter may be crossed, resulting in increased distortion.

If the speaker or the speaker cable suffers short circuit or malfunction, and the loading is below the normal level, the amplifier will get distortion or no sound, and the red clip LED light will flicker more, or the protect LED light will be on. Refer to the malfunction prompt stated at the LCD. the other speakers or cable should be used for inspection.

If impedance of each channel is less than 2 ohms, connecting too much speakers will be very easy to get the amplifier overload and burnt.

If the sound is distorted or not clear, but the red CLIP LED does not flicker, thus there is no distortion within the amplifier. Speaker may be damaged or input signal gets distortion.

1. Use other equipment to check whether the speaker is in good condition or not.
2. If the amplifier's gain control sets over low, it may lead to input over load and over-loaded operation of input source. Thus reduce the volume until the distortion disappears, and raise the amplifier gain to idea level. Generally, it is better to set the gain at the max level (0dB) or close to max level.

3. Check all input connection. Don't connect two different sound source with the same channel. Suggest using mixer to mix the sound resource.

No sound, only with green "ON" LED lighting
Confirm if the gain control is turned on. Confirm if both ends of the input cable is installed correctly. Confirm if there is audio input. If needed, use other sound sources to check or connect other amplifier to present sound source to check.

No sound but signal LED with slight light states
that the amplifier has signal output, so sound shall be heard if connect the speaker. Use another speaker to check the connection of speaker.
No sound: PRT and lighting TEMP LED
If amplifier is with serious over heat and in silence as well, keep the amplifier as it is until it turns cool. The fans will run in full speed, but the sound will be recovered in several minute. If the amplifier touches hot, and the fans don't work, maintenance for amplifier is required.

Amplifier drones

Balanced XLR cable is more suitable for long distance operation. If the unbalanced connection (single-core cable) is adopted, drone may be a problem since generally the single-core cable leads in interference.

According to the different connecting type, drone may appear earlier in the signal chain. If the total power is not too large, it will benefit a lot to make all plug in the same AC jumper.

Finally, moderate drone sometimes can be reduced through decreasing amplifier gain and raising high source gain for compensation. But the sound source must be guaranteed offering large enough sound so as not to cause over load distortion. If the drone isn't reduced, perhaps it is from sound source.

The amplifier is required maintenance in the condition below:

1. If the amplifier smokes or smells burning.
2. If the cabinet has severe indentation and deformation
3. If the amplifier are dipped into the water
4. If the internal components loosen
5. If the switch trip when be powered.

Disclaimer

As a manufacture, SAE CO., LTD affords no responsibility for any damage of speakers or other equipment caused by negligent or inappropriate installation and operation.

SAE CO., LTD offers 2 years warranty for this product.

SAE CO., LTD guarantees that this product has no material / technical defect during two years from the sales date;

if the damage caused under the normal installation and operation, SAE CO., LTD shall change the defective component and repair faulty product for free according to this Quality Guarantee Agreement. However, users must send the product to our factory or any authorized maintenance points or designated distributors, affording the re-paid freight, together with buying proof (including customer copy of product warranty card and payment receipt or invoice copy).

As per this Quality Guarantee Agreement, the returned product must be judged having manufacturing defect itself after our inspection. This agreement doesn't apply for products with damage caused by any wrong operation negligence, accident, inappropriate installation or products with no date code and sequence no or damaged ones beyond recognition.

SAE CO., LTD shall not afford responsibility for any damage caused by accident or indirect factors. The agreement authorized you specific legal rights.

Address:

SAE CO., LTD After Sale Department

39, East, Wenjiao Road, Heshun, Nanhai, Foshan, Guangdong, China

PC:

528241

Tel:

+86-0757-8560 8331

Fax:

+86-757-8568 8191

Email:

support@saechina.com

Brand website:

www.famousound.com

Website:

www.saeaudio.com

www.famousound.com